



**ELECTRIC
ACTUATORS**

**SPECIAL
ACTUATORS**



 **centork**
VALVE CONTROL

HYDRAULIC AND PNEUMATIC

Based on the reliable and well proven Centork electric actuators design, the Special multiturn actuators are completing the need, in certain industries, for actuators with a hydraulic or pneumatic supply media in multiturn applications with position and applied torque control.

Consisting basically in the use of hydraulic or pneumatic motors instead of the usual electric motor. With this solution all the mechanical characteristics of the Centork electric actuators are maintained, but using hydraulic or pneumatic supply.

HYDRAULIC MOTOR

Reversible vane motor that includes a wide range of supply pressures and flow rates (30 to 120 bars).

PNEUMATIC MOTOR

Reversible vane motor with supply pressures from 2 to 10 bars.

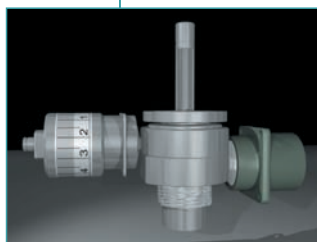

PTCS

Patented planetary gearing system, controlling the applied torque, that features:

- High mechanical efficiency (>95%).
- Precise control of the applied torque/thrust.
- Silent service.
- Highly reduced volume.

The gearing are lubricated for life, therefore reducing maintenance.

AMBIENT PROTECTION

All the Centork actuators are IP67 (IP68 as option). Different painting protection coatings for highly corrosive atmospheres (ships, offshore platforms) are available. Options for different explosive atmospheres protection degrees.

ACTUATOR-VALVE COUPLING

Based on ISO 5210 or 5211 standards, features different couplings modes for all types of valves.



QUARTER-TURN ACTUATORS. 4HO - 4PO SERIES + CW (+FCW)

MODELOS		4HO-006+CW045	4HO-006+CW100	4HO-012+CW200	4HO-025+CW400	4HO-012+CK70	HIGHER TORQUES
Maximum Torque	Nm	550	1000	2100	4000	6300	>7000
Output Flange	ISO5211	F07/F10	F10/F12	F14	F16	F25	On demand
Operating time for 90° at 50Hz	sec.	4-102	5-136	5-136	5-136	15-637	On demand
Supply		Pneumatic: 3 to 10 bar		Hydraulic: 30 to 140 bar			

ACTUATORS. 4HO & 4PO SERIES

ELECTRICAL CONNECTION

All the electrical signals wiring is integrated in a single enclosure protected from the ambient conditions (IP67 or IP68 protection).

SWITCHING AND SIGNALLING UNIT

Including all the electric actuators characteristic elements, integrated in a single control unit.

MANUAL OPERATION

Provides emergency manual operation. The motor drive priority is always maintained.

OPTIONS

- Switching and signalling unit:
 - Torque switches.
 - Limit switches. Double limit switches.
 - Potentiometer.
 - Electronic position transmitter (4-20 mA).
 - Mechanical position indicator.
- Hydraulic supply Oil Set or Pneumatic supply Air Set.
- Hydraulic or Pneumatic Control cabinets.

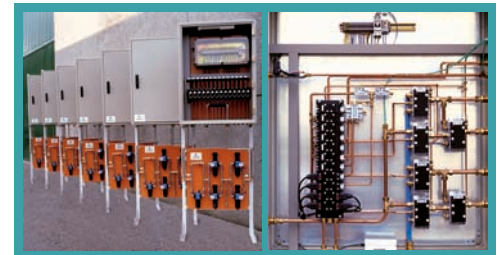

- Centronik unit. Integration on DCS systems.
- Digital communication. Fieldbuses.
- ATEX Certification. Eexia (intrinsic safety) or Eexd (explosion-proof) protection modes.



MULTITURN ACTUATORS. 4HO / 4H1- 4PO / 4P1 SERIES

MODELS		4H0-006/4H1-006	4H0-012/4H1-012	4H0-025/4H1-025	4H1-050	4H1-100	4H1-200
Maximum Torque	Nm	60	120	250	500	1000	2000
Output Flange	ISO5210	F07/F10	F10	F14	F14	F16	F25
Available speeds	1/min.	7-224	4-175	4-175	4-175	2-56	2-28
Supply		Pneumatic: 3 to 10 bar		Hydraulic: 30 to 140 bar			



LINEAR ACTUATORS. 4HO - 4PO SERIES + LC

MODELOS		4H0-006+LC23	4H0-012+LC38	4H0-025+LC64	4H1-050+LC125	4H1-100+LC200
Maximum Thrust	KN	23	38	64	125	200
Output Flange		F07/F10	F10	F14	F16	F16
Available speeds	mm/min.	30-280	38-336	36-392	36-392	40-448
Supply		Pneumatic: 3 to 10 bar		Hydraulic: 30 to 140 bar		



1797CATESPCX001

@ CODIGO

CENTORK VALVE CONTROL, S.L.

Portu Etxe, 23-25 - E 20018 SAN SEBASTIÁN

Apdo. 735 - 20080 San Sebastián

Tfno.: 34 943 31 60 31 - Fax: 34 943 21 76 75

E-mail: actuador@centork.com

<http://www.centork.com>

